

25230

Face Driver Sets Type CoA



Type

Basic body with morse taper shank, guided, spring-loaded centring point, axially adjustable, clamp-on driving plates with hydraulic adjustment for even clamping force, quick exchange of the different driving plates. Chucking circle Ø 12-32 mm, turning range 13-64 mm.

Contents:

- 1 body,
- 2 driving plates chucking circle Ø 12 and 32 mm,
- 2 centring points Ø =6 and 16mm, in cardboard box.

Use

For turning between centres for series and one-off production, for small and medium-sized workpieces. Workpieces can be machined over their entire length with high precision without reloading.

For clockwise operation.

Note:

Larger face drivers, also for counterclockwise rotation, available on request.

25230



Morse taper shank	25230	...
3		101
4		102
5		103

25233

Individual Parts for Face Driver Sets Type CoA



Type

Body.

Without centring point and without driving plate.

Use

For clockwise and counterclockwise operation.

25233



Size	Morse taper shank	25233	...
1	3		101
2	4		102
3	5		103

25235 - 25239

Individual Parts for Face Driver Sets Type CoA



25235

Driving plate, serrated.

Use

For clockwise operation.

25236

Driving plate, serrated.

Use

For counterclockwise operation.

25239

Centring point

25235

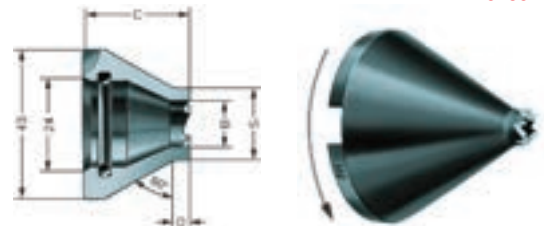

25239

Chucking circle Ø S	for turning range	B	C	D	suitable Centring point Ø A	25235	...	25236	...	25239	...
mm	mm	mm	mm	mm	mm						
8	9 - 16	4,5	38	4	4		101		101		101
10	11 - 20	4,5	38	4	4		102		102		101
12	13 - 24	7,0	36	4	6		103		103		102
16	17 - 32	11,0	33	4	10		104		104		103
20	21 - 40	13,0	30	4	12		105		105		104
25	26 - 50	17,0	30	8	16		106		106		105
32	33 - 64	22,0	30	10	16		107		107		105

25240 - 25241 Driving Plates for Sets Type CoA



Type  
With exchangeable carbide dogs 6 x 3,2 mm.

25240  
Use  
For clockwise operation.

25241  
Use  
For counterclockwise operation.

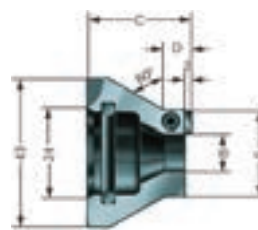

25240



cw rotation 25240 ... ccw rotation 25241 ...

Chucking circle Ø S mm	for turning range mm	B mm	C mm	D mm	suitable Centring point Ø A mm	25240	...	25241	...
20 H	21 - 40	7	30	5	6		101		101
25 H	26 - 50	11	30	8	10		102		102
32 H	33 - 64	17,5	30	10	16		103		103

25243 Spindle Sleeves



Use  
For mounting face drivers into lathe chucks.

25243

MT internal	A mm	B mm	C mm	D mm	G mm	25243	...
3	31	39	32	40	23,825		101
4	39	47	42	50	31,267		102
5	54	62	52	60	44,399		103
6	75	83	62	70	63,448		104

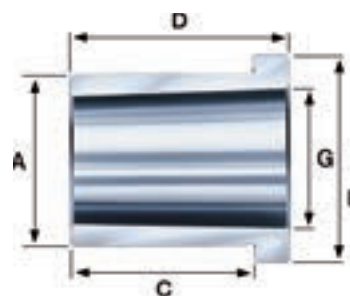

# DATA MATRIX //DMC ... scan and be done!

■ Select articles

Select your articles from the catalogue in the customary manner, find the associated Data Matrix code in the table.

■ Shopping cart

The data will be automatically transferred into the shopping cart. Close your order by pressing the confirm key.

■ Scan

Scan in the desired article. Entry is confirmed and concluded by the peep tone.

■ OCI / ePos / etc.

Naturally the purchase orders can also be transferred into your OCI-capable enterprise resource planning system. For this additional settings may be required.

■ Interface

Connect the scanner to a computer and the Internet via the provided docking station. Then confirm the webshop access with your password.

■ Curious?

Schedule a meeting with our regional sales manager.

